



Industrial signal light specially designed for tower and harbour cranes. Sturdy and reliable, it features a high degree of customization.

FEATURES

- Sturdy industrial signal light suitable for tower and harbour cranes.
- It features two to four Universal Signal Beacons and a Wall-Mounted Siren.
- Specially designed to guarantee excellent long-distance visibility.
- Featuring polycarbonate lenses and an ABS housing mounted on an aluminium plate.
- IP protection degree: the industrial signal light is classified IP65.
- Extreme temperature resistance: -20°C to +50°C.
- All materials and components used are wear resistant and guarantee protection of the unit against water and dust.

OPTIONS

- Possibility to switch the light modes by pressing a specific button on the switch board.
- Featuring customizable plate and configuration.
- Available with continuous or intermittent sound siren, or without.

CERTIFICATIONS

- CE marking.



CERTIFICATIONS

Conformity to Community Directives	2014/35/UE Low Voltage Directive
Conformity to CE Standards	EN 60598-1 Luminaires - General requirements and tests EN 60529-1 Degrees of protection provided by enclosures
Markings and homologations	CE

GENERAL TECHNICAL SPECIFICATIONS

Ambient temperature	Operational -20°C/+50°C
IP protection degree	IP 65
Materials	Lens: Polycarbonate
	Housing: ABS
	Plate: aluminium
Lens diameter	90 mm
LED module type	5 x 3 W Power LED
LED life duration	50.000 hrs
Power supply	12 - 24 V AC/DC
	40 - 230 V AC/DC
Current max	660 mA
Light colours	White, red, yellow, green
Light modes	Steady, flashing, strobing, rotary
Sound	2 sounds
Volume	121 dB (10 cm) - 100 dB (100 cm)
Light changing button	Yes
Connections	M12 male connector - 5 PIN (signal light with 2 lights)
	M12 male connector - 8 PIN (signal light with 4 lights)

OVERALL DIMENSIONS (mm)

Signal light with 2 lights + siren

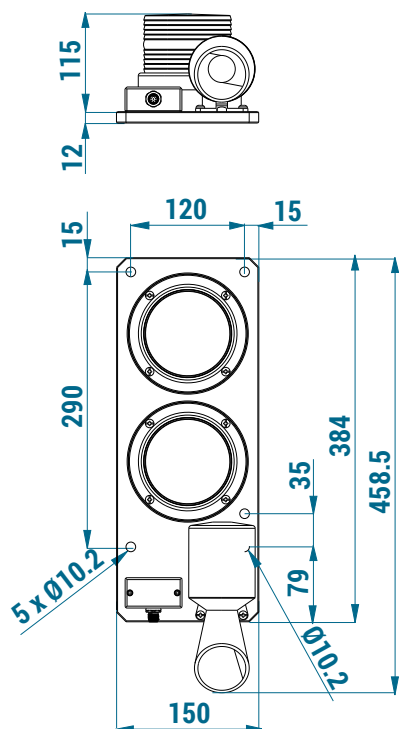

Signal light with 4 lights + siren

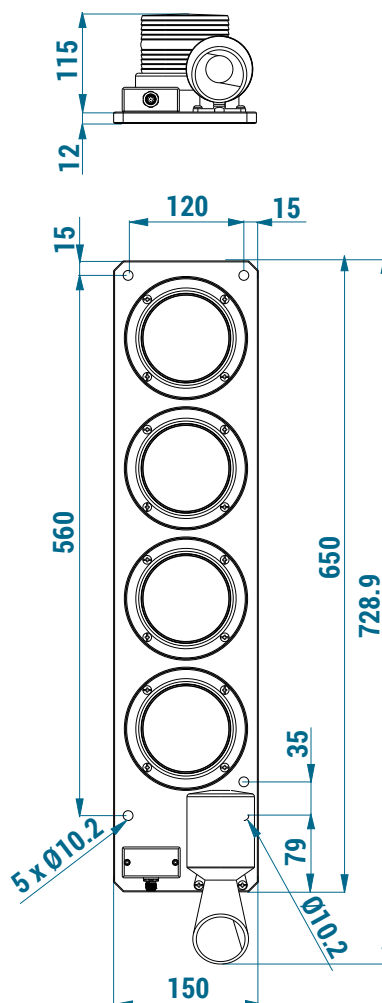

CONNECTOR ASSIGNMENT (front view)

5 PIN connector (signal light with 2 lights)

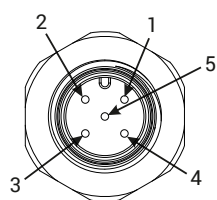

PIN	Description
1	Siren
2	Light 2
3	Light 1
4	Not used
5	0 V

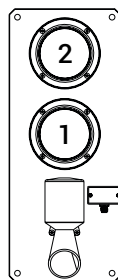

8 PIN connector (signal light with 4 lights)

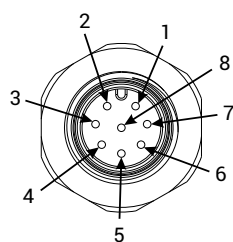

PIN	Description
1	Siren
2	Light 4
3	Light 1
4	Light 2
5	Light 3
6	Not used
7	Not used
8	0 V



INDUSTRIAL SIGNAL LIGHT - REQUEST FORM

Instructions

- 1 Model:** choose the desired model, then, for each light, enter the letter corresponding to the requested colour into the circles.
- 2 Siren:** if the model with siren is required, indicate the type of sound desired.
- 3 Power supply:** select the type of power supply required.

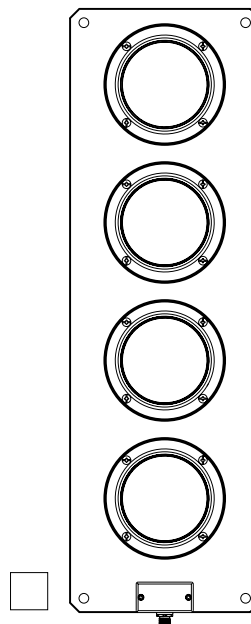
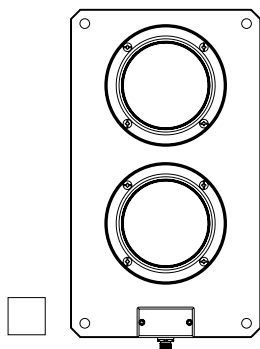
Without siren **1** W White R Red Y Yellow G Green

With siren

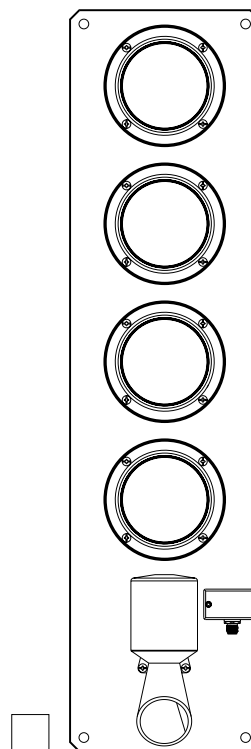
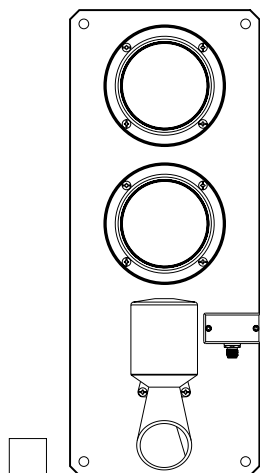
 W White R Red Y Yellow G GreenSiren **2**

- ☐ Siren with continuous sound
- ☐ Siren with intermittent sound

Power supply **3**

- ☐ 12 - 24 V AC/DC
- ☐ 40 - 230 V AC/DC