

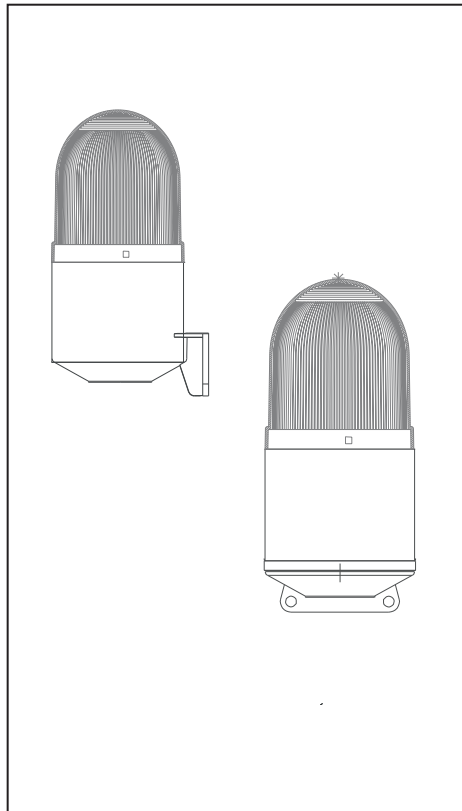

TERMWL0300
TERMWL0301

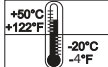

(EN)

- Electrical connection is to be made by trained electrical specialists only.
- The product can be used indoors & outdoors.
- The interior & exterior compatibility of the product is like in the pictures below.
- The product should be installed where the vibration and heat is minimum.

INDOOR

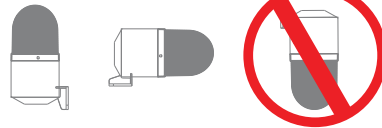

OUTDOOR

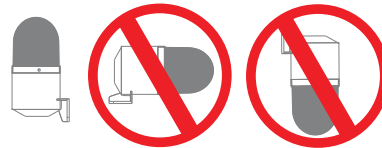

TERMWL03 Model

P/N	Power Supply	Current (mA) Max.
TERMWL0300	12-24V /DC	190mA
TERMWL0301	40-250 AC/DC 50Hz	45mA



Light Pattern

P/N	Light Pattern	Melody
TERMWL0300	Flashing Strobe	16
TERMWL0301	Slow Flashing Steady	



Sound Intensity

Melody	Sound Intensity (dB max) (10cm)	Sound Intensity (dB max) (100cm)
M1	99-111	87-98
M2	99-111	88-100
M3	91-109	77-93
M4	97-106	77-89
M5	106-116	91-99
M6	105-116	86-98
M7	88-108	73-90
M8	89-112	76-96
M9	99-113	84-96
M10	99-112	85-98
M11	71-116	67-99
M12	113-116	96-99
M13	108-111	93-99
M14	101-111	85-98
M15	113-123	92-102
M16	114-122	92-102

*** Values may vary by +/- 5%.



Weight

P/N	Weight	Color
TERMWL0300	225-235gr	Red Green Blue Yellow
TERMWL0301	265-275gr	



*It is recommended that people with epilepsi should not use it.



T.E.R. Tecno Elettrica Ravasi Srl a socio unico
Via Garibaldi 29/31 - 23885 Calco (LC) - Italy
Tel. +39 039 9911011 - Fax +39 039 9910445
E-mail: info@ter.it - www.ter.it
Sede Legale - Registered Office
Via San Vigilio 2 - 23887 Olgiate Molgora (LC) - Italy

1

TECHNICAL DIAGRAM

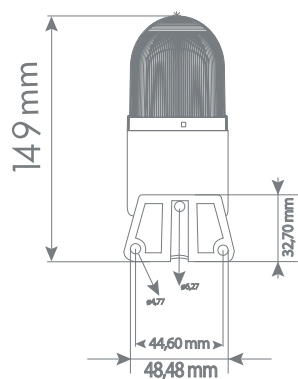
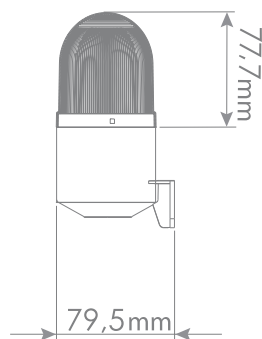
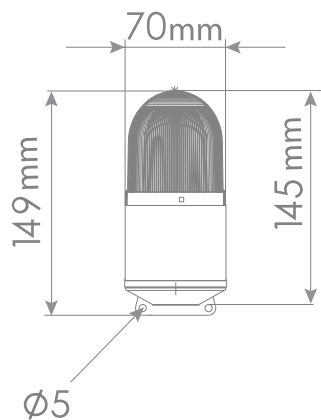

2

WIRING DIAGRAM

12-24V DC

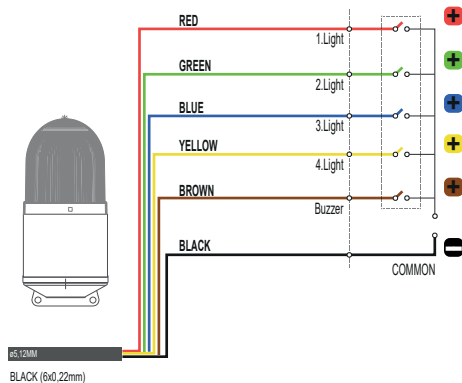

2a

WIRING INSTRUCTION

12-24V DC

EN

Light Wires: Red-Green-Blue-Yellow

Buzzer Wire: Brown

Common Wire: Black

- The 12-24V DC RGB series products are current-protected.
- The Melody and Buzzer wires can be connected to the NPN/PNP terminals of a PLC.
- When the cable specified is triggered, the corresponding light and melody are activated. In the event of multiple triggers, the product operates according to the color sequence, with priority given in the following order: **Red, Green, Blue, Yellow.**

3

WIRING DIAGRAM

40-250V AC/DC

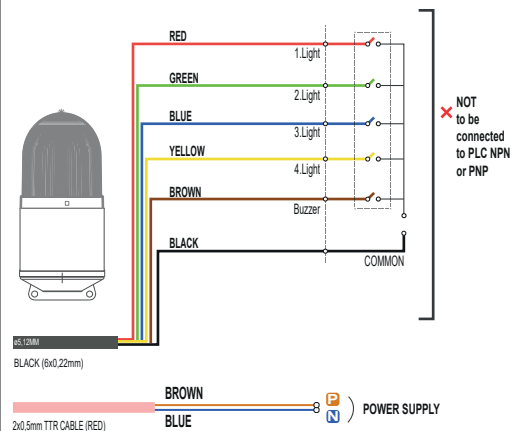

3a

WIRING INSTRUCTION

40-250V AC/DC

EN

Light Wires: Red-Green-Blue-Yellow

Buzzer Wire: Brown

Common Wire: Black

Power Supply Cable: 2x0,50 TTR (Blue-Brown)

- Do not supply power to the Light, Buzzer and Common Wires, and do not connect directly to PLC NPN or PNP terminals to avoid damage or malfunction. Only the power supply wires should be used to provide power to the system.
- The product warranty will be void if power is supplied to the Light, Buzzer and Common Wires.
- For Light and Buzzer, make a dry contact connection between the Light, Buzzer and the Black Common wire.
- When the cable specified is triggered, the corresponding light and melody are activated. In the event of multiple triggers, the product operates according to the color sequence, with priority given in the following order: **Red, Green, Blue, Yellow.**

4

LIGHT&MELODY ADJUSTMENT

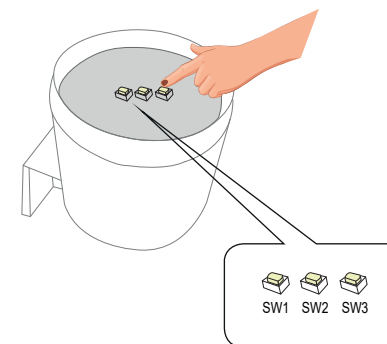

- SW1: Light mode selection button.
- SW2: Melody selection button.
- SW3: Sound Intensity selection button.

- VOL1: 25% - lowest volume
- VOL2: 50% - medium level volume
- VOL3: 100% - highest volume

5

SPARE PARTS

