

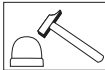

TERMWL09***

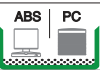

- Electrical connection is to be made by trained electrical specialists only.
- The product can be used indoors & outdoors.
- The interior & exterior compatibility of the product is like in the pictures below.
- The product should be installed where the vibration and heat is minimum.

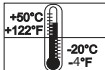

TERMWL09 Model

P/N	Power Supply	Current (mA) Max.
TERMWL0900 TERMWL0901	12-24V /DC	190mA
TERMWL0902 TERMWL0903	40-250 AC/DC 50Hz	45mA



Light Pattern

P/N	Light Pattern	Melody
TERMWL0900	Flaşör / Flashing	X
TERMWL0902	Çakar / Strobe	X
TERMWL0901	Yavaş Flaşör / Slow Flashing	16
TERMWL0903	Sabit / Steady	16



Sound Intensity

Melody	Sound Intensity (dB max) (10cm)	Sound Intensity (dB max) (100cm)
M1	90-99	76-83
M2	90-102	74-86
M3	81-93	64-78
M4	77-94	61-76
M5	87-97	72-83
M6	87-100	70-82
M7	81-90	69-72
M8	77-91	66-78
M9	80-89	70-74
M10	82-91	72-78
M11	86-96	71-88
M12	83-94	74-82
M13	83-92	70-78
M14	82-93	71-78
M15	85-95	76-80
M16	82-92	66-76

*** Values may vary by +/- 5%.



Weight

P/N	Weight	Color
TERMWL09***	245-255gr	Red Green Blue Yellow
TERMWL09***	280-290gr	



*It is recommended that people with epilepsi should not use it.

LIGHT&MELODY ADJUSTMENT

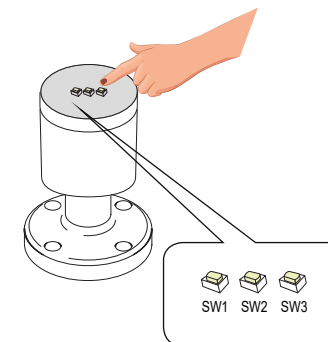

SW1: Light mode selection button.



SW2: Melody selection button.



SW3: Sound Intensity selection button.

- VOL1: 25% - lowest volume
- VOL2: 50% - medium level volume
- VOL3: 100% - highest volume



T.E.R. Tecnica Elettrica Ravasi Srl a socio unico
Via Garibaldi 29/31 - 23885 Calco (LC) - Italy
Tel. +39 039 9911011 - Fax +39 039 9910445
E-mail: info@ter.it - www.ter.it
Sede Legale - Registered Office
Via San Vigilio 2 - 23887 Olgiate Molgora (LC) - Italy

1

TECHNICAL DIAGRAM

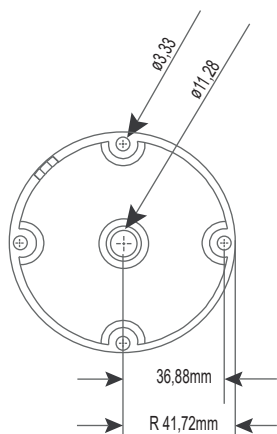
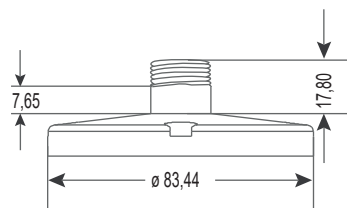
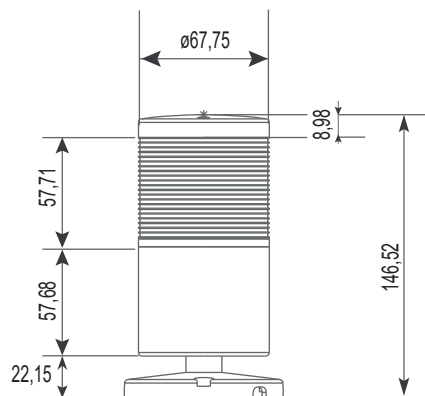

2

WIRING DIAGRAM

12-24V DC

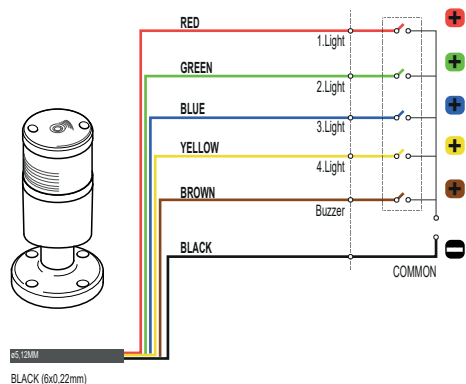

2a

WIRING INSTRUCTION

12-24V DC

(EN)

Light Wires: Red-Green-Blue-Yellow
Buzzer Wire: Brown
Common Wire: Black

- The 12-24V DC RGB series products are current-protected.
- The Melody and Buzzer wires can be connected to the NPN/PNP terminals of a PLC.
- When the cable specified is triggered, the corresponding light and melody are activated. In the event of multiple triggers, the product operates according to the color sequence, with priority given in the following order: **Red, Green, Blue, Yellow.**

3

WIRING DIAGRAM

40-250V AC/DC

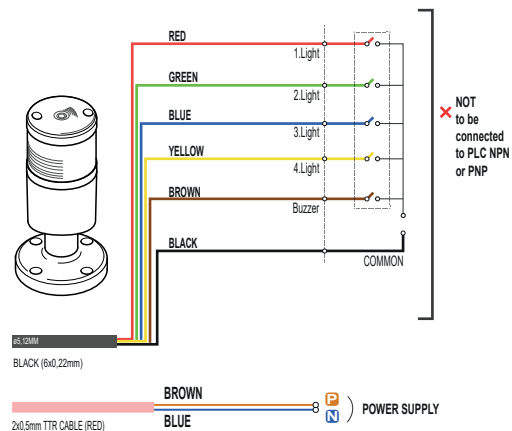

3a

WIRING INSTRUCTION

40-250V AC/DC

(EN)

Light Wires: Red-Green-Blue-Yellow
Buzzer Wire: Brown
Common Wire: Black
Power Supply Cable: 2x0,50 TTR (Blue-Brown)

- Do not supply power to the Light,Buzzer and Common Wires, and do not connect directly to PLC NPN or PNP terminals to avoid damage or malfunction. Only the power supply wires should be used to provide power to the system.
- The product warranty will be void if power is supplied to the Light,Buzzer and Common Wires.
- For Light and Buzzer, make a dry contact connection between the Light,Buzzer and the Black Common wire.
- When the cable specified is triggered, the corresponding light and melody are activated. In the event of multiple triggers, the product operates according to the color sequence, with priority given in the following order: **Red, Green, Blue, Yellow.**

4

SPARE PARTS

